

Plans for your town

Horley High Street and subway improvements

Initial consultation feedback

Earlier in the year, we asked Horley residents, businesses and visitors to provide feedback on how we might shape future improvements to Horley's High Street and subway.

We had a really great response to our survey with nearly 400 responses - so a big thank you to everyone who took part!

We want to share with you what people told us and how, as a result, we are now shaping plans for the High Street and subway.

Objectives

Attractive: creating an attractive place



Safe: a place where people feel safe



Green: a place that is greener



Active: creating a place that can be used for different activities



Historical: a place that connects with its heritage



Design ideas

In helping to shape ideas, we said that we thought it was important to have:

1. a high street that is safer and easier to use with wider pavements, and to remove parking
2. places for people to sit to rest and to meet others
3. an environment that was less car dominated, with reduced speeds (20mph speed limit)
4. safer cycle routes and cycle parking in appropriate locations
5. street planting and trees for shade, shelter and biodiversity
6. better signage and opportunities for public art.

The results of the consultation can be viewed at: www.reigate-banstead.gov.uk/delivering-change

What people told us

- There was a **great level of support** from people in relation to almost all the design ideas.
- People were asked whether they fully, largely or partially supported the design ideas or if they didn't support them at all.
- **Make it greener!** 78% of people said they fully or largely supported more trees and street planting.
- **Make it safer!** 63% of people said they fully or largely supported reducing the amount of traffic and speeds, including the introduction of a 20mph speed limit.
- **Make it more pedestrian friendly!** 53% of people said they fully or largely supported creating a better environment for pedestrians that is easier to use, with wider pavements and the removal of on street parking. Some people wanted to go even further and fully pedestrianise the High Street.
- **Make it more cycle friendly!** 49% of people said they fully or largely supported providing safer cycle routes and parking to promote cycling.
- **Make it more active!** 55% of people said they fully or largely supported providing places for seating to rest and or to socialise.
- **Make it easier to navigate!** 61% of people said they fully or largely supported new signage and public art.
- **Make the subway better!** The subway is well used by local people, but there is a high level of awareness of its maintenance issues and many people said that it was or felt unsafe.

What else we have done

Since we undertook the survey, we have also:

- updated traffic and parking surveys
- looked how any proposals would affect existing junctions and neighbouring streets
- been speaking to key stakeholders like Horley Town Council and Horley Town Management Group
- worked with Surrey County Council to review the findings of the Reimagining Horley visioning work to ensure that the outcomes and priorities are integrated with our proposals.



Existing pedestrian precinct

High Street pedestrianisation

In the consultation feedback, a number of people suggested that the High Street could be pedestrianised, in a similar way to the precinct. Since the consultation, the Borough Council, County Council and design team explored this further to understand if a space like the pedestrian precinct could be created between Albert Road and Consort Way East.

Although pedestrianisation presents several benefits, especially for pedestrians, it also presents a number of issues:

- potential for safety issues with pedestrians and cyclists mixing
- restricted hours for delivery and servicing of High Street businesses
- no space for vehicles to turn if they approach the pedestrianised area from Albert Road
- conflict between pedestrians, cyclists and servicing vehicles out of hours.

For these reasons, this option has not been taken forward.

The High Street proposals

Having considered everything that people said, we have developed an exciting proposal for the High Street which promises to provide an attractive, greener and safer town centre that reduces the dominance of the car and provides more space for people to enjoy.

To do this we propose:

- wider footpaths on both sides of the High Street from Albert Road to Consort Way East by narrowing the carriageway to 3m and removing on street car parking
- a short one-way system along the High Street from Albert Road to Consort Way East for vehicles
- a dedicated cycle lane for cyclists travelling towards the precinct
- raised pedestrian tables at key junctions and dropped kerbs
- relocating of disabled car parking bays a short distance to either Albert Road and or Lumley Road
- new street trees and areas of dedicated planting called 'rainwater gardens'
- new dedicated seating areas and street furniture
- a new loading bay for businesses.

Key benefits:

- a more attractive and greener town centre that is less car dominated
- more room for people to walk safely on wider footpaths
- safer and more accessible crossing points
- better and safer facilities for cyclists
- more space for businesses to provide outside tables and chairs
- more space for activities and events in the town centre, like for St Georges Day
- very little impact on nearby junctions or on adjacent streets.



Initial proposal for the High Street

Design ideas

Seating

Seating will provide opportunities to rest and meet others.
The introduction of planting will create a more pedestrian friendly environment.

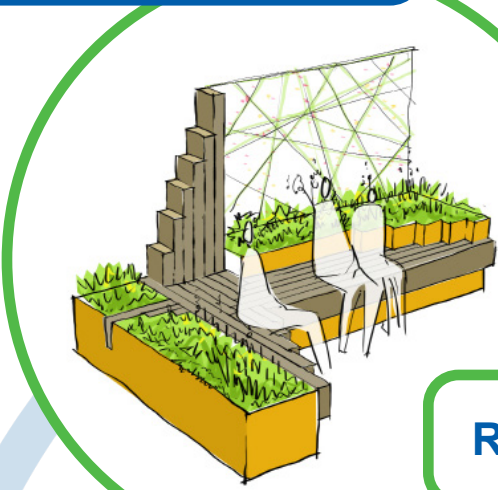

Canopy shelter

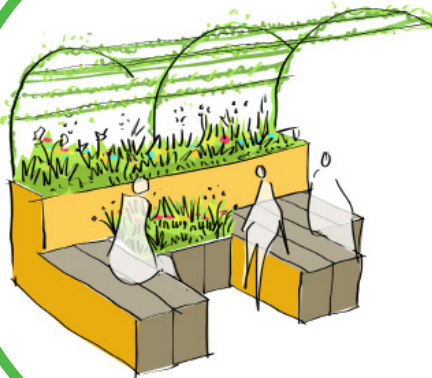

Social spaces

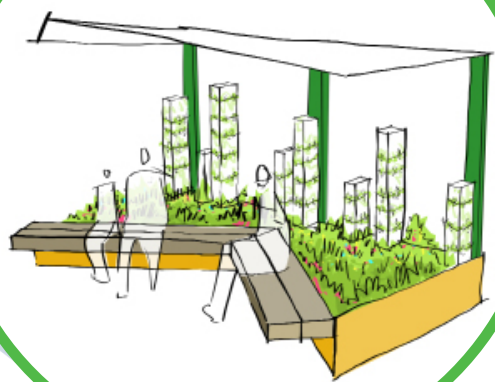

Raised planters

Reclaimed sleepers

Rain gardens

Surface water along the High Street will be collected in rain gardens. The water will be channelled from the road into the planted areas.
Planting will help to improve biodiversity and create a greener and more colourful environment, something many people said they wanted in the consultation.
Planting will also act as a natural filtration system helping to treat polluted water from the road.

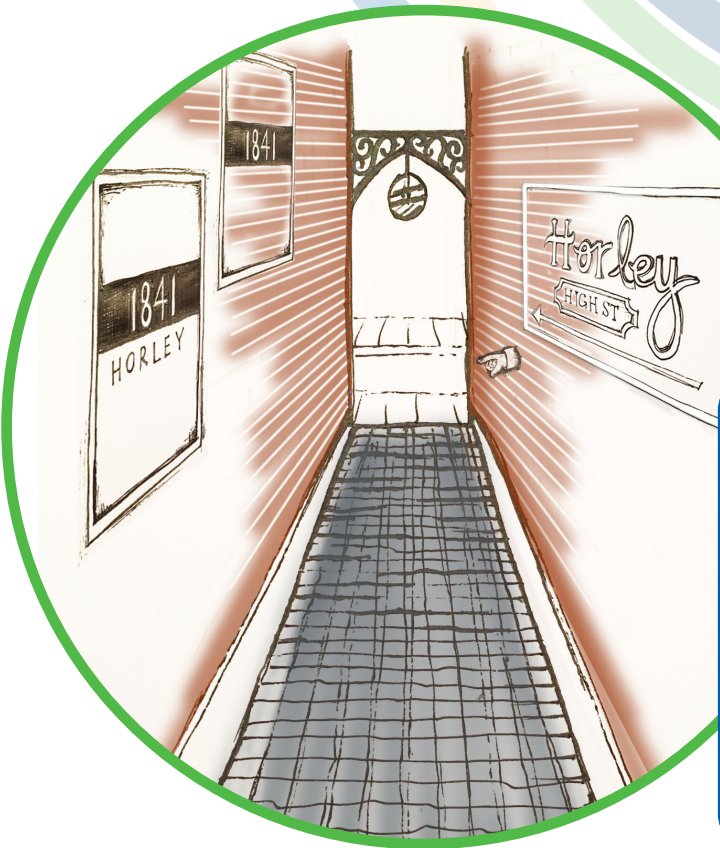
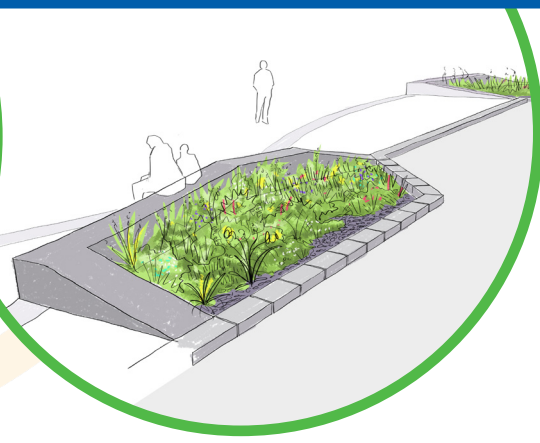
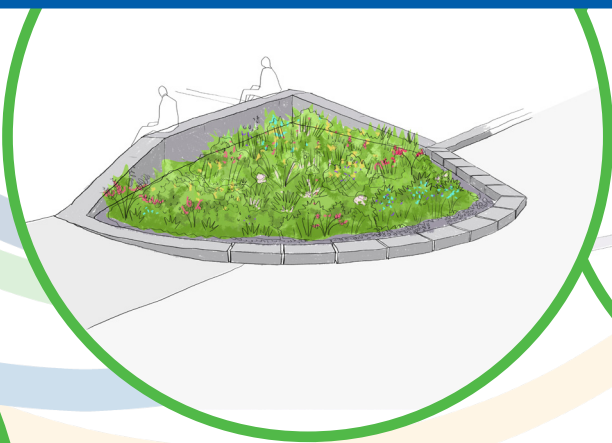

Diana Walk

Enhancements to Diana Walk would improve the sense of arrival for visitors coming into the High Street from Central Car Park.
The introduction of good quality paving with integrated lighting and art will enhance the quality of the space.
(Improvements are subject to agreement with the landowner).

Subway improvements

Improvements to the subway will be delivered in two stages.

Stage one will look at resolving the flooding issues. Reigate & Banstead Borough Council is working in closely with Network Rail to improve the drainage in the subway. Works are expected to be carried out in the autumn (2022).

Stage two will look at improving the look and feel of the subway. Works are being developed and could include:

- opening up the entrance to the subway, including planting and steps
- a potential canopy to cover part of the subway
- introducing art and or lighting in the walls to create a better quality environment
- improvements to the railway boundary fences.

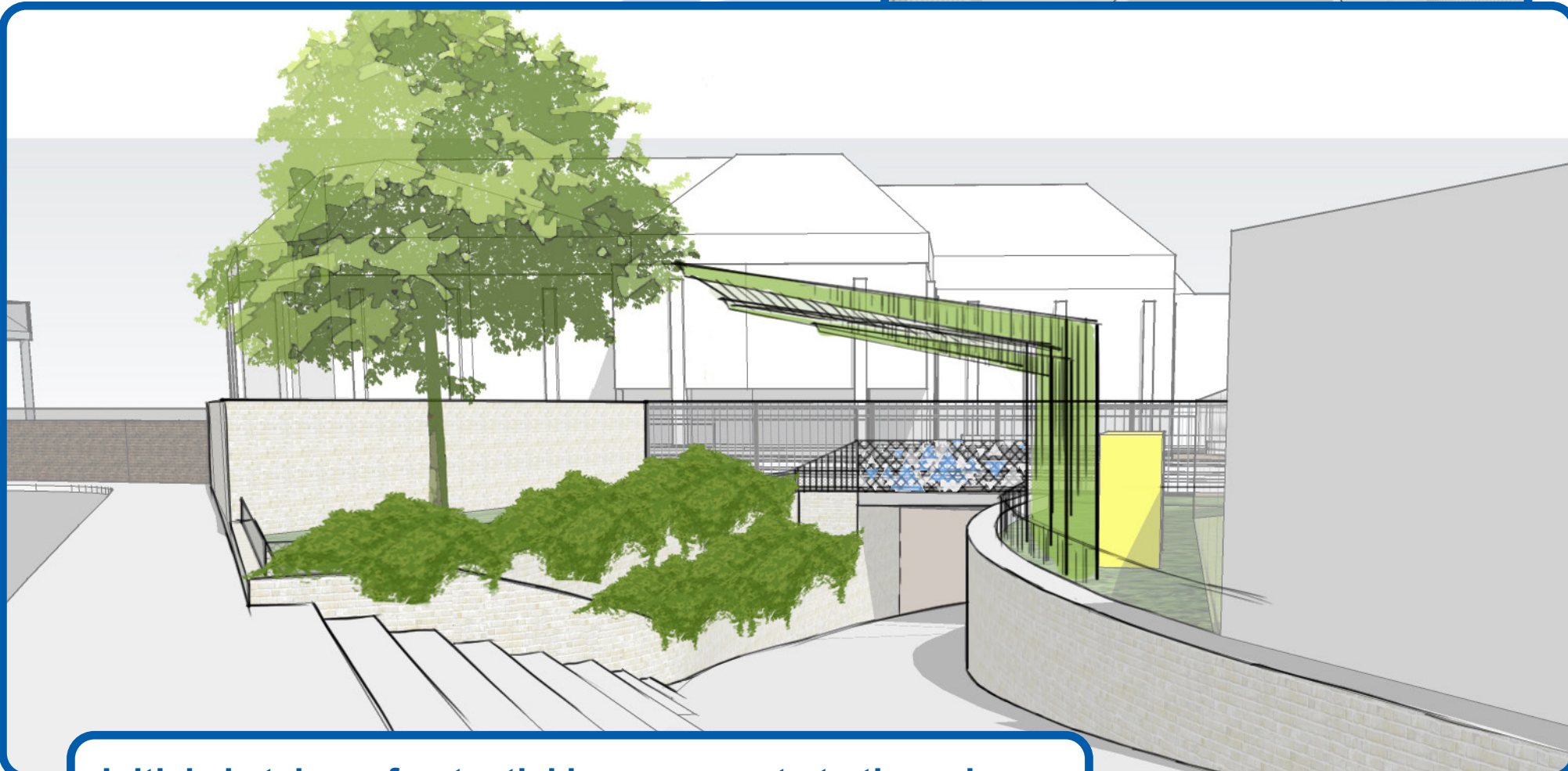
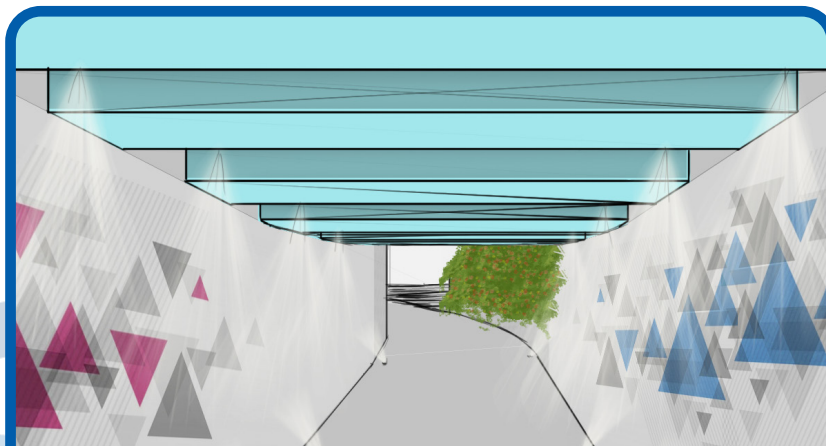

Initial sketches of potential improvements to the subway

What's next?

The Borough Council is working with a design team to develop detailed proposals over the summer (2022) and we aim to consult again on the detailed proposals in the autumn (2022).

For more information on the Delivering Change in Horley projects, please visit:

www.reigate-banstead.gov.uk/delivering-change.

If you have any additional suggestions or concerns, you can contact us by email:

HorleyTownCentre@reigate-banstead.gov.uk.

For more information on Re-imagining Horley - a vision and a plan for Horley town centre that reflects the aspirations of the local community - please visit: **www.surreycc.gov.uk/horley**.